

**NSF** 3003 SUPER ALUMINUM COOKWARE

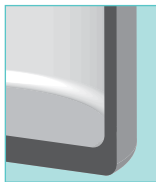

Sturdy handles



Extra thick reinforced base



AXHB-28



AXHA-60



AXHH-40

**SUPER ALUMINUM EXTRA-HEAVYWEIGHT COOKWARE**

**6.0 MM, 1/4" THICKNESS**

- ◆ Extra-durable 6mm thick aluminum core ensures long-lasting performance through constant heating & washing
- ◆ 3003 Aluminum for superior heat distribution
- ◆ Riveted handles designed for strength & durability
- ◆ Wide base & high walls allow for recipe versatility

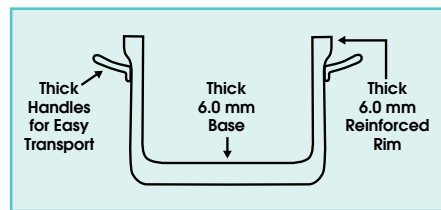

**EXTRA HEAVYWEIGHT ALUMINUM STOCK POTS**

ITEM	DESCRIPTION	SIZE (DIA X HEIGHT)	UOM	CASE
AXHH-12	12 Qt	10" x 9-1/4"	Each	1
AXHH-16	16 Qt	10" x 12"	Each	1
AXHH-20	20 Qt	12" x 10-1/2"	Each	1
AXHH-24	24 Qt	12" x 12-1/2"	Each	1
AXHH-32	32 Qt	13" x 14"	Each	1
AXHH-40	40 Qt	14" x 15"	Each	1
AXHH-60	60 Qt	16" x 17"	Each	1
AXHH-80	80 Qt	18" x 18-1/4"	Each	1
AXHH-100*	100 Qt	20" x 19"	Each	1
AXHH-120*	120 Qt	20" x 23"	Each	1
AXHH-120H*	120 Qt, 4 Hdl	20" x 23"	Each	1

\*Replaces ALHP-Series

**EXTRA HEAVYWEIGHT ALUMINUM SAUCE POTS**

ITEM	DESCRIPTION	SIZE (DIA X HEIGHT)	UOM	CASE
AXHA-8	8 Qt	10" x 6-1/8"	Each	1
AXHA-14	14 Qt	12" x 7-3/4"	Each	1
AXHA-20	20 Qt	13" x 9-1/4"	Each	1
AXHA-26	26 Qt	14" x 10-1/4"	Each	1
AXHA-34	34 Qt	16" x 10-1/4"	Each	1
AXHA-40	40 Qt	16" x 11-3/4"	Each	1
AXHA-60	60 Qt	18" x 13-3/4"	Each	1

**EXTRA HEAVYWEIGHT ALUMINUM BRAZIER**

ITEM	DESCRIPTION	SIZE (DIA X HEIGHT)	UOM	CASE
AXHB-15	15 Qt	14" x 5-7/8"	Each	1
AXHB-18	18 Qt	16" x 5-13/32"	Each	1
AXHB-24	24 Qt	18" x 5-5/8"	Each	1
AXHB-28	28 Qt	18" x 6-7/16"	Each	1
AXHB-35*	35 Qt	21-3/4" x 6"	Each	1
AXHB-40*	40 Qt	22-7/8" x 6"	Each	1

\*Replaces ALBH-Series

**COVERS**

ITEM	UOM	CASE
AXS-16C	Each	6
AXS-16C	Each	6
AXS-20C	Each	6
AXS-20C	Each	6
AXS-32C	Each	6
AXS-40C	Each	6
AXS-60C	Each	6
AXS-80C	Each	6
AXS-100C*	Each	6
AXS-100C*	Each	6
AXS-100C*	Each	6

\*Replaces ALPC-Series

**COVERS**

ITEM	UOM	CASE
AXS-16C	Each	6
AXS-20C	Each	6
AXS-32C	Each	6
AXS-40C	Each	6
AXS-60C	Each	6
AXS-60C	Each	6
AXS-80C	Each	6

**COVERS**

ITEM	UOM	CASE
AXS-40C	Each	6
AXS-60C	Each	6
AXS-80C	Each	6
AXS-80C	Each	6
AXS-100C*	Each	6
AXS-100C*	Each	6

\*Replaces ALPC-Series