



ABBB-95 3 SOLID DOOR BACK BAR

INCLUDE 3 YEAR PARTS + LABOR / 5 YEAR COMPRESSOR WARRANTY

Dimensions

Exterior Dimensions (WxDxH)	95.28" x 26.30" x 37"
Interior Dimensions (WxDxH)	
Capacity (cu. ft.)	33.6 cu. ft.
Weight	348 lbs
Packaging Dimensions (WxDxH)	

Construction

Exterior Material	EGI(Electro Galvanized Iron) + Black Embossed Painting
Interior Material	Galvalume
Insulation Material	Cyclopentane
Shelf Material	SWRM-B + PE Coating
Shelf Load Capacity	132 lbs/EA
# Shelves	6

Cooling

Temperature Range	32° - 41° F
Refrigerant	R290
Maximum Ambient	95° F
Temperature Rating	N Class
Defrosting	Automatic
Temperature Display	Analog Thermometer
Temperature Controller	Thermostat
H/P	3/8

Electrical

Voltage	115
Amps	3.5A
Hz	60
Phase	10



Front View

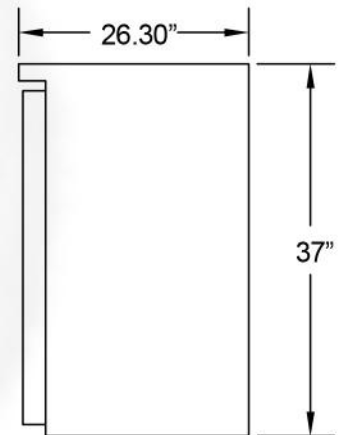

Side View



Top View

