



Project: \_\_\_\_\_

Location: \_\_\_\_\_

Item #: \_\_\_\_\_ Quantity: \_\_\_\_\_

Model #: \_\_\_\_\_

**MODEL: IAG-EML9INOXM1** **AIR CURTAINS – Vertical & Glass Sided – Stainless Steel**



**General Strengths**

- ✓ **Sanitation.** Ability of dismantling the shelves and guides for a correct cleaning of the machine's interior.
- ✓ **Control systems.** Higher precision in managing temperature settings. Greater ability to adjust of temperature ranges as per the end user's requirement.
- ✓ **100% Tested.** All condenser units are tested 100%, in helium chambers to refrigerant leak detections.
- ✓ **Modular Line.**
- ✓ **Certified.** Audited and Certified by **INTERTEK** for compliance with UL 471 and NSF 7. AENOR audited and certified by internationally recognized firm. ISO 9001:2008 (Quality); ISO 14001:2004 (Environmental); OSHAS 18001:2007 (Prevention and Worker Safety)
- ✓ **Lighting.** LED lighting in the canopy and under each shelf, reduces the energy consumption by 80% and 90% compared to a traditional bulb. Provides a much better light quality.

MODEL	Dimensions (inches) (mm)			N° Shelves	Ref.	Ref. Weight (Lbs.) (gr.)	Temp. Range (°F) (°C)	Capacity (Cu. Ft.) (L)	Cond. Unit. H.P.	Case Amps 115V.	Crated Weight (Lbs.) (Kg.)
	W	D	H								
IAG-EML9INOXM1	40	33-1/2	78-3/4	4	R404A	1.21	33°F/41°F	23.7	3/4	13.0	534
	1018	850	2000			550	0°C/5°C	670			240

ETL LISTED TO UL471 STANDARD AND SANITATION CLASSIFIED TO NSF7 – WE RESERVE THE RIGHT TO CHANGE SPECIFICATIONS WITHOUT PRIOR NOTICE



**Infrico USA Corp.**  
 7042 N.W. 46th Street  
 Miami, FL 33166  
 1.305.777.9599 Office  
 1.305.777.9598 Fax

[www.infrico.us](http://www.infrico.us)  
 service@infrico.com  
 sales@infrico.com

**APPROVALS: AVAILABLE AT**



Project: \_\_\_\_\_

Location: \_\_\_\_\_

Item #: \_\_\_\_\_ Quantity: \_\_\_\_\_

Model #: \_\_\_\_\_

**MODEL: IAG-EML9INOXM1**

**AIR CURTAINS – Vertical & Glass Sided – Stainless Steel**

**STANDARD FEATURES**

➤ **Exterior**

- AISI 304 Stainless Steel,
- Pull down night curtain,
- Glass sided panels,
- Heavy duty ball transfer and levelling feet.

➤ **Interior**

- AISI 304 Stainless Steel,
- Stainless Steel internal panel perforated,
- **LED lighting** in canopy and under each shelf.

➤ **Shelving**

- (4) Four rows of adjustable shelves,
- Price channels included.

➤ **Insulation**

- CFC-Free polyurethane insulation, entire cabinet structure is foamed-in place using a high density polyurethane insulation,
- Low GWP & Zero ODP effect.

➤ **Refrigeration**

- Digital temperature controller with automatic defrost system,
- **Double Stainless Steel evaporative pan system, first, by hot gas, second, by electrical resistance,**
- Extractable condensing unit for easy service,
- Forced air refrigeration system,
- Case engineered to operate at 75°F (25°C). and 55% relative humidity,
- Refrigeration capacity: 4962 Btu/h(5°F) / 1454 W(-15°C).

**OPTIONAL FEATURES**

- ✓ Electrical connection is 230V / 1ph / 50 Hz (plug type varies).

➤ **Electrical**

- Cord and NEMA 5-20P plug,
- Electrical connection is 115V / 1ph / 60 Hz.



- **ETL Listed to UL471 Standard and Sanitation classified to NSF7.**

**PLAN VIEW**

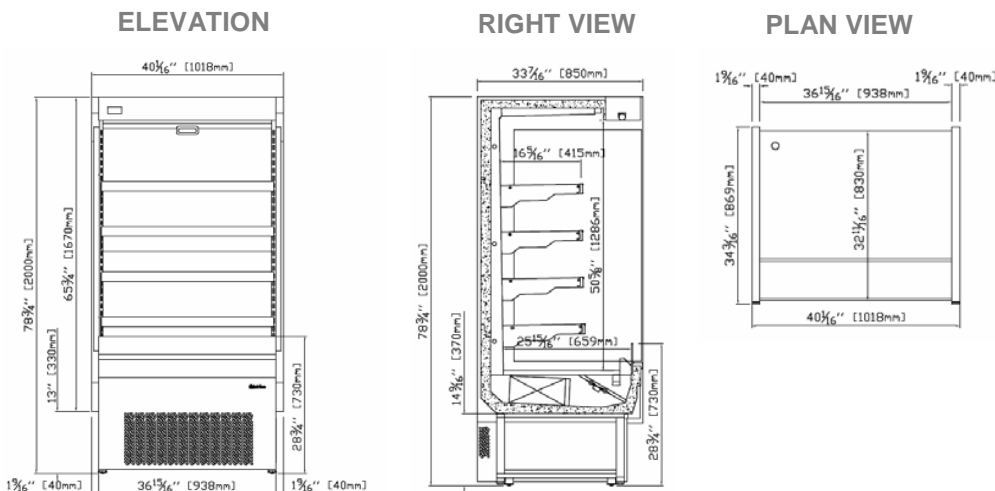

ETL LISTED TO UL471 STANDARD AND SANITATION CLASSIFIED TO NSF7 – WE RESERVE THE RIGHT TO CHANGE SPECIFICATIONS WITHOUT PRIOR NOTICE



**Infrico USA Corp.**  
 7042 N.W. 46th Street  
 Miami, FL 33166  
 1.305.777.9599 Office  
 1.305.777.9598 Fax

[www.infrico.us](http://www.infrico.us)  
 service@infrico.com  
 sales@infrico.com

**APPROVALS: AVAILABLE AT**