

GLASS DOOR BACK BAR COOLERS

EBB - Series • EBB23G • EBB48G • EBB48G-SS • EBB59G • EBB59G-SS • EBB69G • EBB90G



▲ EBB23G



▲ EBB48G



▲ EBB48G-SS



▲ EBB59G



▲ EBB59G-SS



▲ EBB69G



▲ EBB90G

Cabinet Construction

- Heavy duty stainless steel countertop with textured laminate, black vinyl exterior. Stainless steel exterior for models EBB48G-SS and EBB59G-SS.
- Galvanized steel interior walls and high quality stainless steel floor.
- 1 3/4" thick high density polyurethane insulation.
- Four pre-installed 5" swivel casters with locks on front set (applies only to model EBB23G).
- Built-in caster thread receptacles for all models.

Refrigeration System

- Side mounted, self-contained and fully detachable Blizzard R290 condensing unit uses environmentally friendly, EPA-compliant R290 refrigerant with zero (0) Ozone Depletion Potential (ODP) and three (3) Global Warming Potential (GWP). Blizzard R290 is easily replaceable and requires no on-site brazing (Blizzard R290 condensing unit is back mounted for model EBB23G).
- Electronically commutated (ECM) fan motors achieve rapid cooling with less energy consumption.
- Full-length air duct system ensures optimal circulation of cold air.
- Time-initiated and temperature-terminated auto defrost cycle for seamless operation.
- Large capacity, corrosion-resistant condenser and evaporator coils.
- Self-maintaining, energy-efficient condensate drain pan requires no external drains or electric heaters.
- High performance, auto-reverse condenser fan motor supports compressor ventilation and condenser coil cleaning. Refer to owner's manual for full maintenance instructions.
- Pre-wired and ready to plug, 115V/60Hz/1Ph, NEMA 5-15P.

Lighting

- Shielded LED bar lighting with on/off switch provides bright, high color illumination at lower heat output.

Doors

- Low emissivity double glass panes reflect UV rays for efficient cooling.
- Black PVC door frames. Matte finish aluminum door frames for models EBB48G-SS and EBB59G-SS.
- Snap-in magnetic door gasket make cleaning and replacement an easy process.
- High strength, die-cast door handles.
- Pre-installed door locks keep your items safe from theft.

Shelving

- Two epoxy coated, steel wire shelves per section.
- Height adjustable stainless steel clips.

Temperature Control

- Multi-function digital controller with easy to read LED display.
- Factory preset temperature, 35°F. Temperature setting range from 33°F to 54°F.
- Audible overheat protection alarm for compressor and condenser coil.

Options

- Additional shelving.
- 3" or 5" swivel casters with locks.
- 3.5" – 6" height-adjustable and interchangeable legs.



Dimensions

Side View (all models except EBB23G)

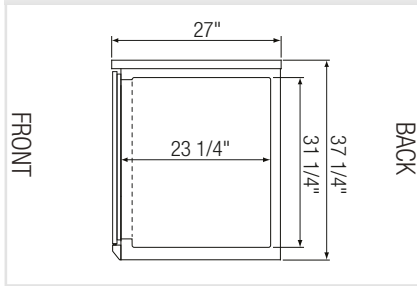

Side View (EBB23G)

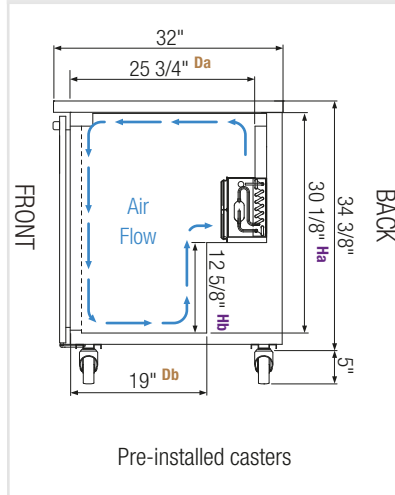

Equipped with 9 ft long NEMA 5-15P plug.

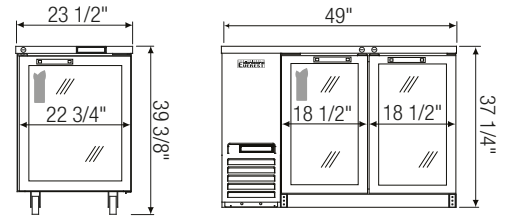
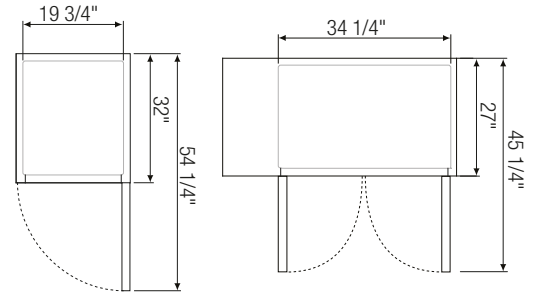

▲ EBB23G

▲ EBB48G(SS)

Air Flow (all models except EBB23G)

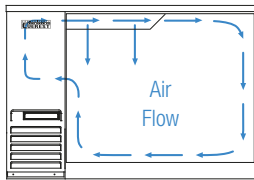

Front view of cabinet interior demonstrates air circulation from left to right.

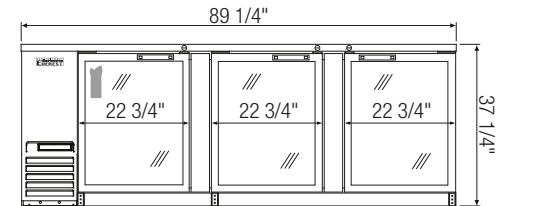
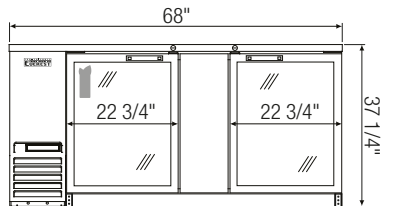
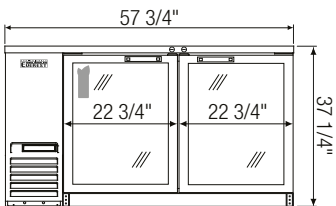
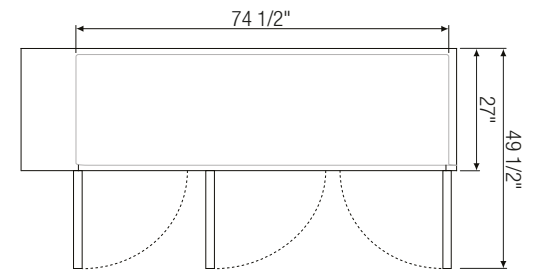
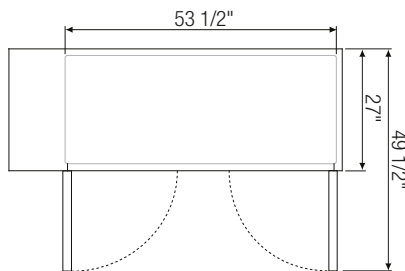
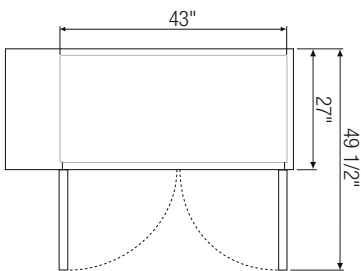

▲ EBB59G(SS)

▲ EBB69G

▲ EBB90G

Model	Ref/ Frz/ Dual	# of Doors	Shelves	Capacity (Cu. Ft.)	HP	BTU/HR †	Refrigerant	Capacity		Power (V-Hz-Ph)	Amps	Crated Weight (LBS)	Exterior Dimensions (Inches)		
								12 oz. Cans	12 oz. Bottles				L	D*	H
EBB23G	Ref	1	2	8	1/5	1,655	R-290	220	125	115-60-1	2.5	179	23 1/2	32	39 3/8 ^a
EBB48G(SS)	Ref	2	4	14	1/4+	1,926	R-290	490	344	115-60-1	3.5	288	49	27	37 1/4
EBB59G(SS)	Ref	2	4	20	1/4+	1,926	R-290	640	408	115-60-1	3.5	313	57 3/4	27	37 1/4
EBB69G	Ref	2	4	24	1/4+	1,926	R-290	800	504	115-60-1	3.5	347	68	27	37 1/4
EBB90G	Ref	3	6	32	1/3	2,311	R-290	1120	696	115-60-1	2.5	472	89 1/4	27	37 1/4

* : Depth does not include protruding door handles.

a : Height includes 5" for casters.

† : Based on evaporating temperature of 23°F (-5°C) & condensing temperature of 131°F (55°C).

Da, Db : Interior Depth Ha, Hb : Interior Height

Specifications subject to change without notice.

Product dimensions are for general purposes and not absolute value. Product capacity () is calculated based on standard industry figures. Slight variations may exist. If dimensions and capacity are critical, please contact Everest Refrigeration.

Ref = Refrigerator



Please visit our website for updated Energy Efficiency information.